

BURNHAM SHORES PLAYGROUND -

EXISTING CONDITIONS

LAST RENOVATION IN 2000

PROJECT SCOPE

- RENOVATE PLAYGROUND
- ADDRESS ADA CONCERNS
- ADDRESS OTHER CONCERNS IDENTIFIED BY RESIDENTS



EXISTING PLAYGROUND LOOKING WEST



PARK AERIAL

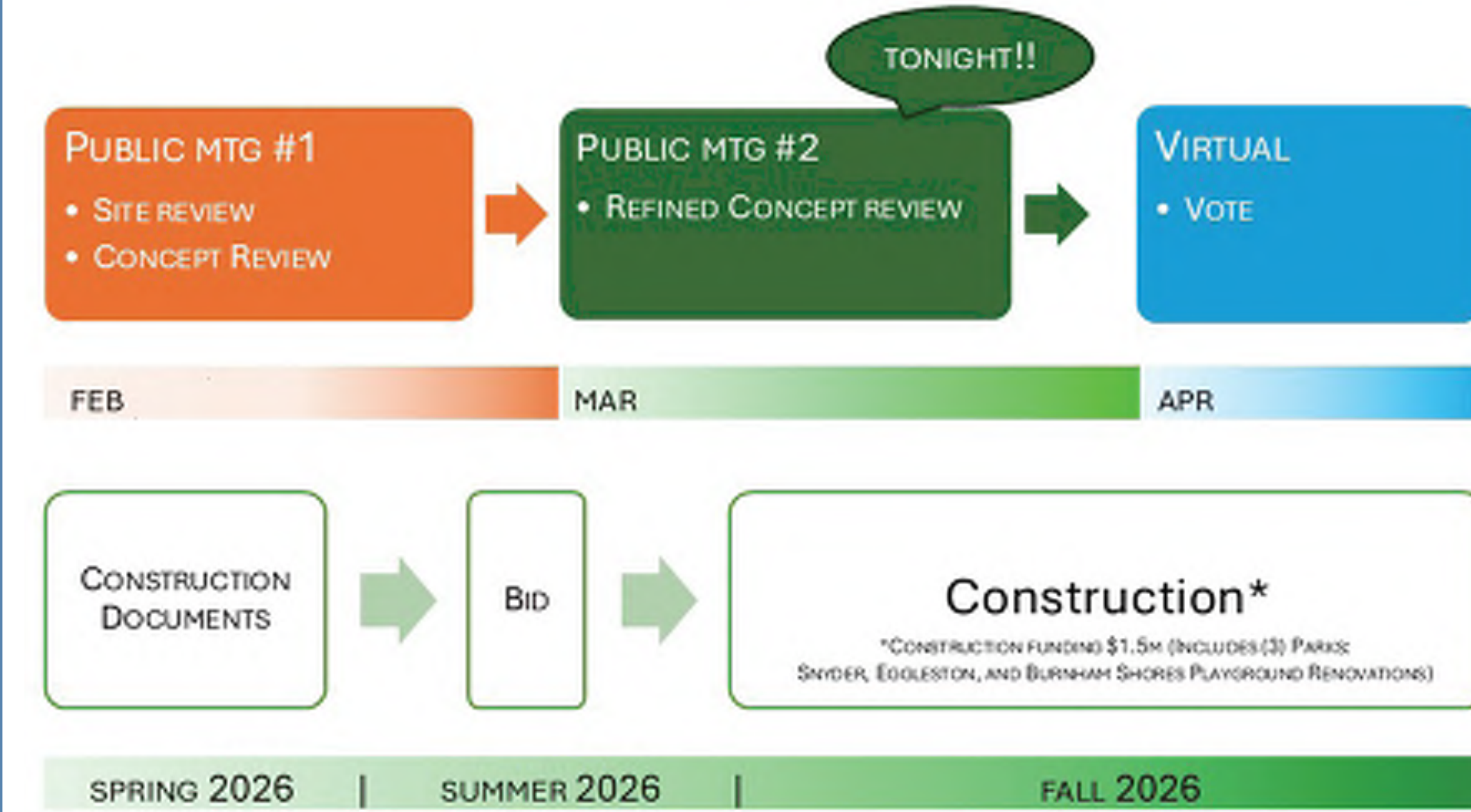

PROJECT TIMELINE



EXISTING PLAYGROUND - STREET VIEW



**TELL US
MORE! ADD
POST-IT
NOTES TO
SQUARES!!**



PARK BENCH



ACCESSIBLE PICNIC TABLE

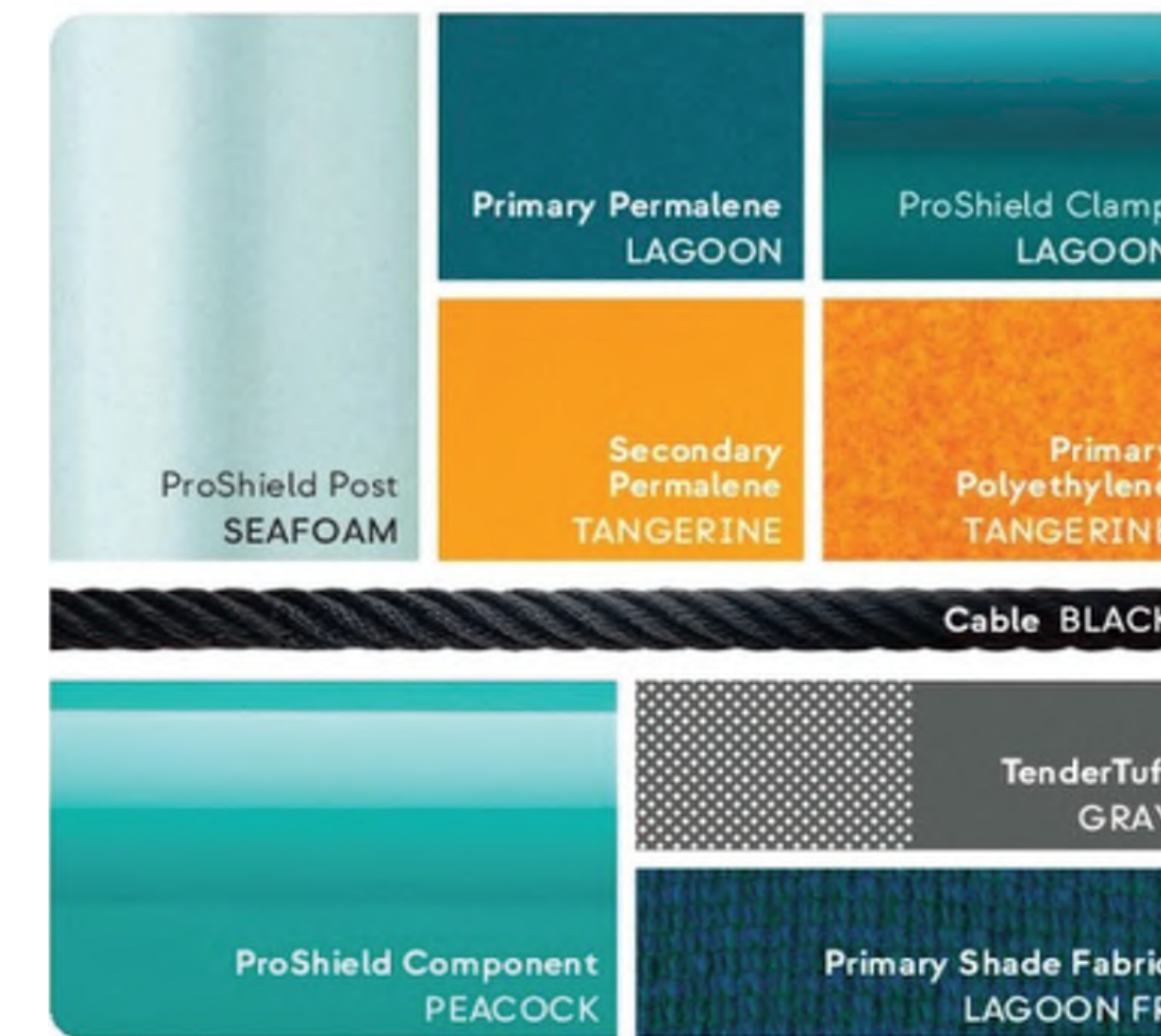

**SELECTED COLOR:
SEAFOAM AND SUNSET**

KEY UPDATES

- CHALLENGE COURSE THEME
- WOOD CHIP PLAY SURFACING

1. AGES 5-12 ROPE STRUCTURE
2. AGES 2-5 PLAY STRUCTURE
3. (5) SWINGS: (2) BELT, (1) ACCESSIBLE, (1) TODDLER, (1) GROUP SWING
4. AGES 5-12 PLAY STRUCTURE WITH ACCESSIBLE RAMP AND MULTI-GENERATIONAL SLIDE
5. AGES 5-12 ROPE CLIMBER

PREVIOUS COMMENTS: 2/17/26 MTG.

- 1.NEED AS MANY SWINGS AS POSSIBLE
- 2.TAKE ADVANTAGE OF LAKE VIEWS
- 3.IMAGINATIVE PLAY
- 4.INTERACTIVE WITH ALL AGES GROUPS INCLUDING THOSE BEYOND 12+ YEARS OLD

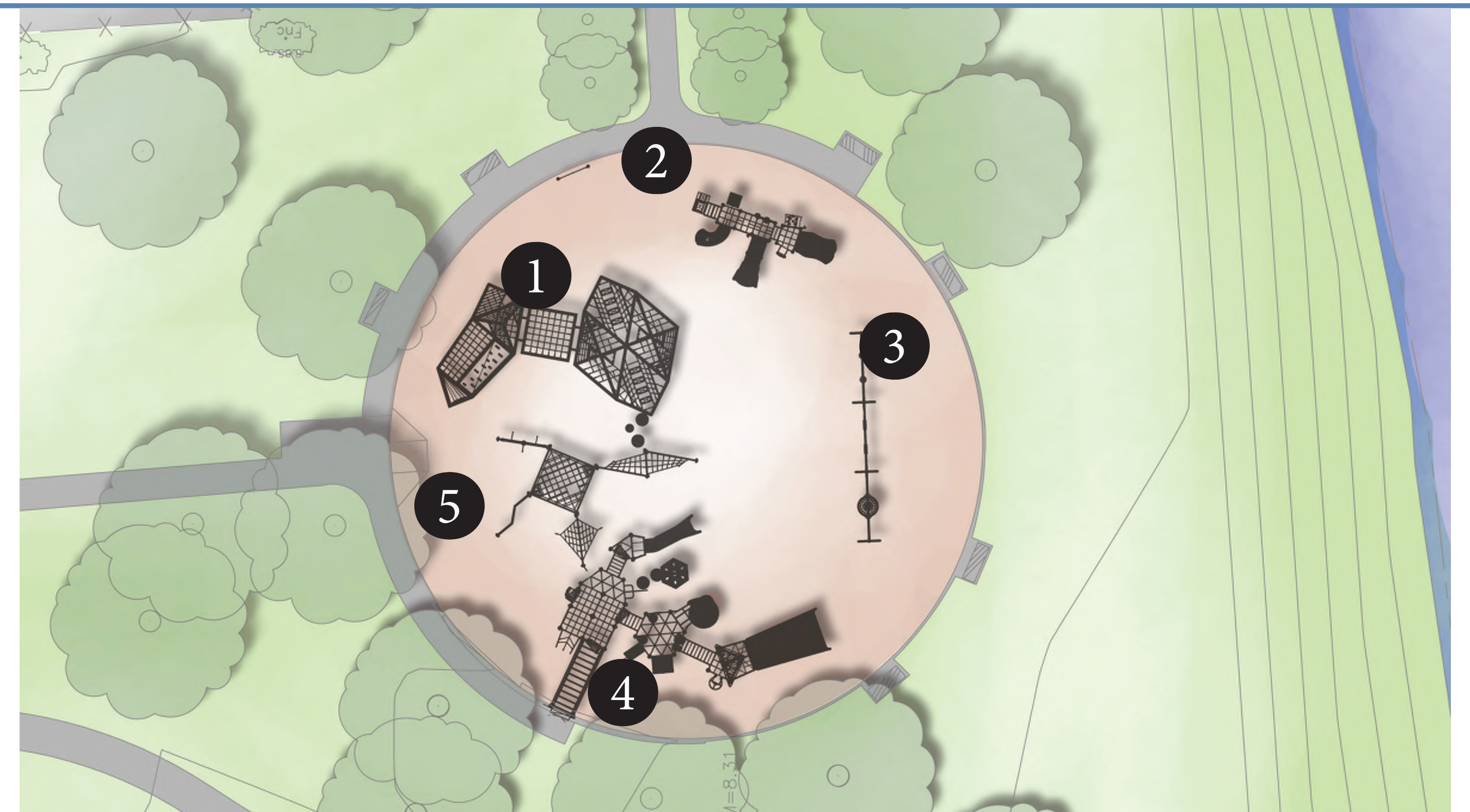

PLAN VIEW



PLAYGROUND ENTRANCE FROM WEST



AERIAL VIEW FROM SOUTH

KEY UPDATES

- SHIP THEME
- WOOD CHIP PLAY SURFACING

1. AGES 2-5 SHIP PLAY STRUCTURE
2. (2) SWINGS: (2) TODDLER
3. SPRINGER
4. (4) SWINGS: (3) BELT & (1) ACCESSIBLE
5. AGES 5-12 SHIP PLAY STRUCTURE WITH ACCESSIBLE RAMP AND INCLUSIVE GLIDER
6. INDIVIDUAL AND GROUP SPINNERS

PREVIOUS COMMENTS: 2/17/26 MTG.

1. AGES 2-5 PLAY STRUCTURE NEAR WEST ENTRANCE WITH SEPARATED TODDLER SWINGS
2. TAKE ADVANTAGE OF LAKE VIEWS
3. WATER BASED THEME
4. IMAGINATIVE PLAY

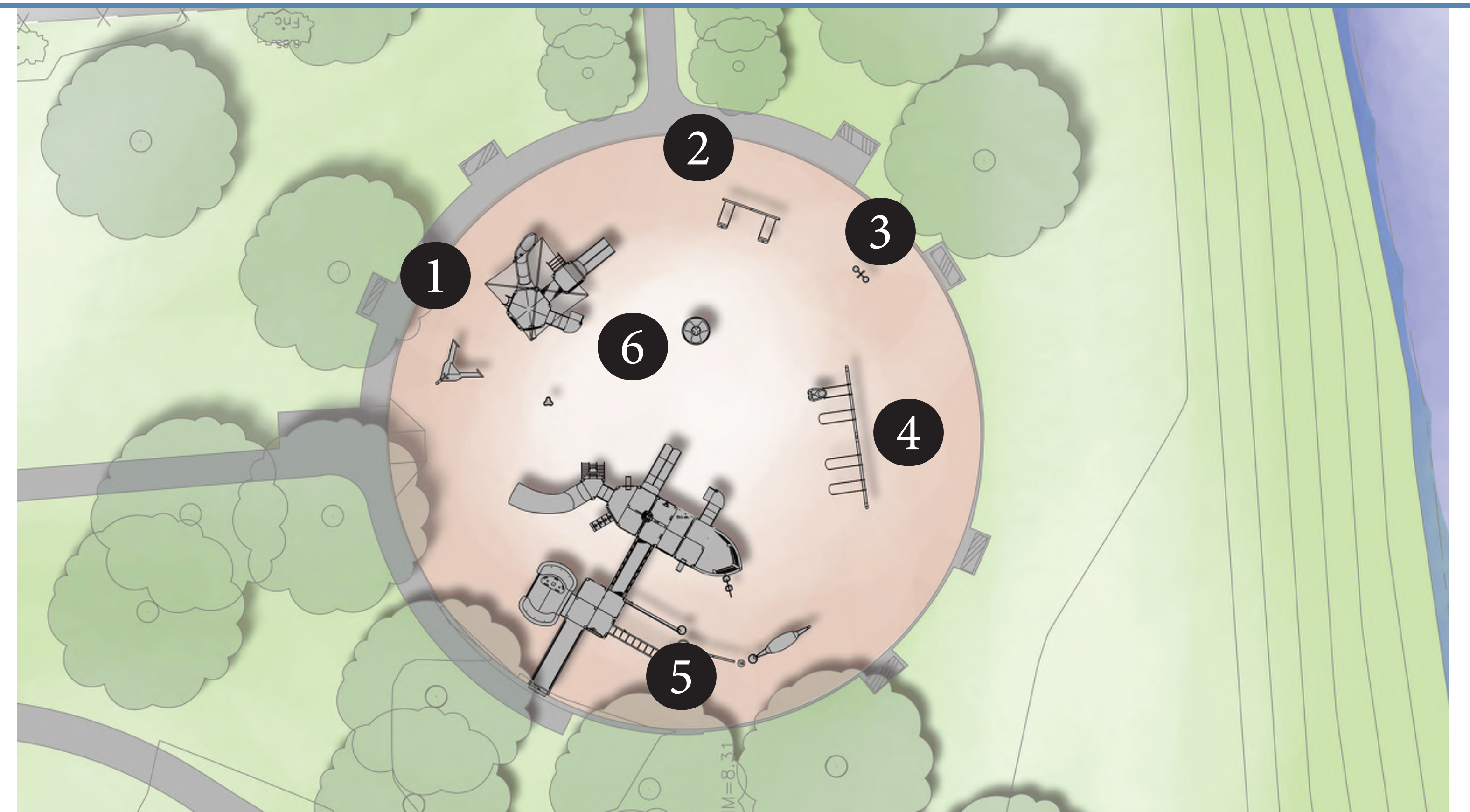

PLAN VIEW



PLAYGROUND ENTRANCE FROM WEST

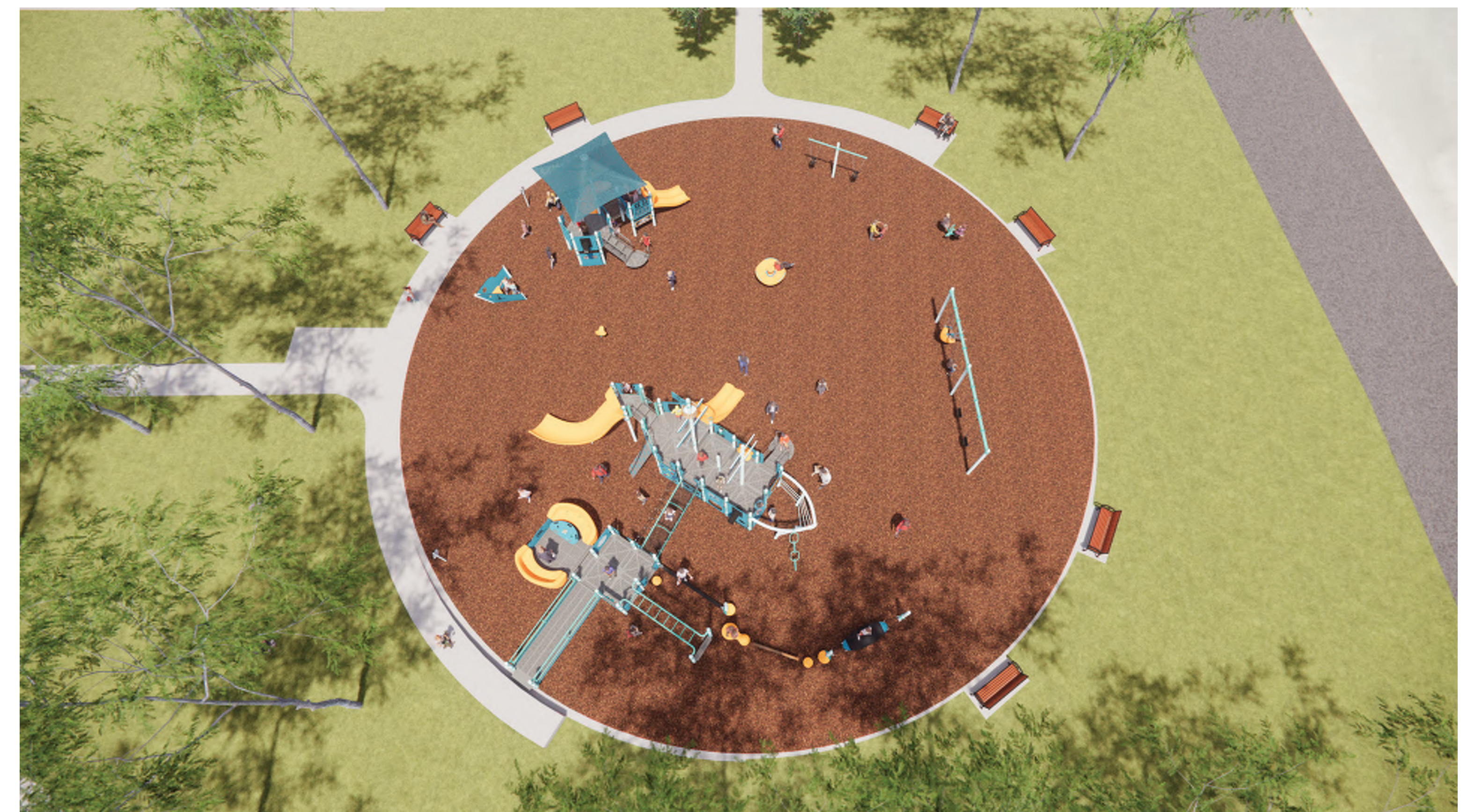

AERIAL VIEW FROM SOUTH

